

- Colour: chrome
- with infrared sensor for bi-directional communication for monitoring, configuration and service purpose
- 6 V lithium battery, type CR-P2
- battery lifetime: approx. 7 years (150 actuations a day)
- GROHE Long-Life finish
- GROHE Water Saving mousseur 5.7 l/min
- flexible connection hoses
- non-return valve
- dirt strainers
- with integrated solenoid valve
- external battery
- rapid installation system
- multistage battery status display
- 7 pre-set programs:
- auto flush
- thermal disinfection
- cleaning mode
- additional functions and precise settings by remote control 36 407
- CE approved
- acoustic group I in accordance with DIN 4109
- type of protection faucet IP 59K
- min. recommended pressure 1.0 bar

36 422 000 EUROSMART COSMOPOLITAN E INFRA-RED ELECTRONIC BASIN MIXER 1/2" L-SIZE WITH MIXING DEVICE AND ADJUSTABLE TEMPERATURE LIMITER

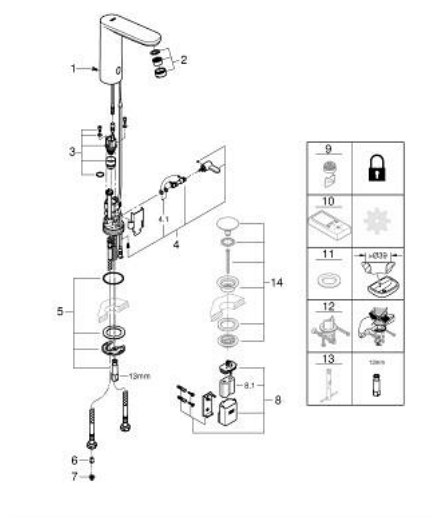

SPARE PARTS, May 2023 – now

- 1: Screw (Order-nr. 4283100M)
 - 2: Mousseur (Order-nr. 48159000)
 - 3: Solenoid valve (Order-nr. 42479000)
 - 4: Mixing lever (Order-nr. 42401000)
 - 4.1: Seat washer (Order-nr. 4284000M)
 - 5: Mounting set (Order-nr. 42400000)
 - 6: Non-return valve (Order-nr. 4257200M)
 - 7: Filter (Order-nr. 4241300M)
 - 8: Battery housing with battery (Order-nr. 42393000)
 - 8.1: Battery (Order-nr. 42886000)
 - 9: Mousseur (Order-nr. 36133000)*
 - 10: Remote control (Order-nr. 36407001)*
 - 11: Escutcheon (Order-nr. 36370000)*
 - 12: Rotation lock (Order-nr. 36276000)*
 - 13: Mounting wrench (Order-nr. 19017000)*
 - 14: Waste set with push-open plug (Order-nr. 65807000)*
- * Optional accessories